



# Using iNaturalist to Connect with Nature



## A Guide for Android Devices

An app that compels users to learn about nature, contribute to community science, dialogue with other naturalists, and get identifications from experts!

### Step 1: Download the App

Search for "iNaturalist" in your smartphone's app store

Allowing the app to turn on location services helps with identification

Allow the app to access your camera and photos

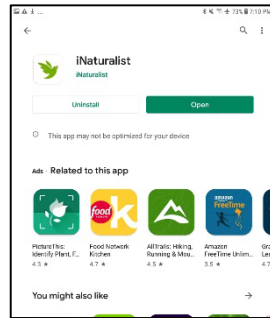

### Step 2: Create an account

Open the app

Select "Sign up now!" and follow the on-screen instructions

Once complete, log in to your account

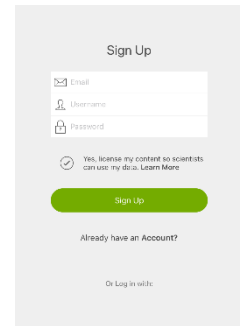

### Step 3: Upload a Photo

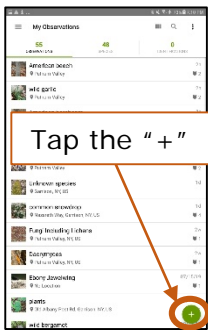

Tap the "+"

Take a Photo: tap the green camera to bring up the camera

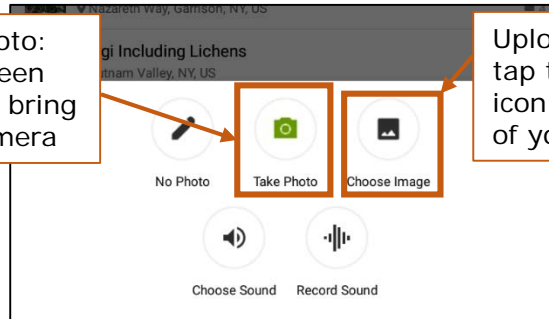

Upload A Photo: tap the photos icon to select one of your images

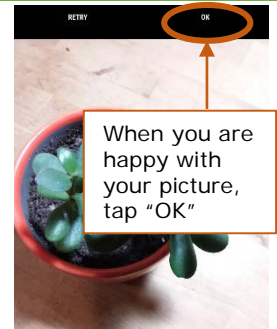

When you are happy with your picture, tap "OK"

### Step 4: Complete your Observation!

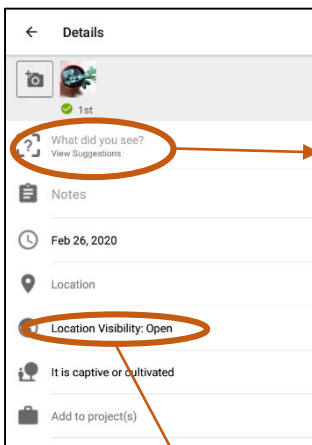

#### Explore & Identify!

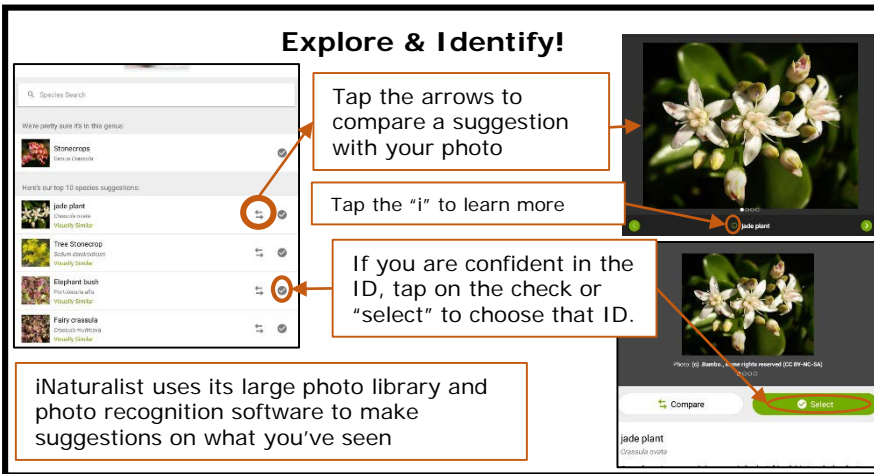

Tap the arrows to compare a suggestion with your photo

Tap the "i" to learn more

If you are confident in the ID, tap on the check or "select" to choose that ID.

iNaturalist uses its large photo library and photo recognition software to make suggestions on what you've seen

Tap the check to save your observation!

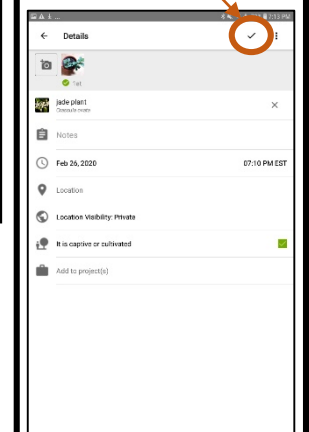

#### Set privacy settings

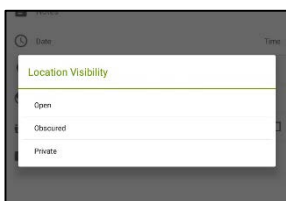

Open: coordinates visible by everyone

Obscured: coordinates randomized within a 12 x 12 square mi area

Private: Coordinates not visible to others

#### Check the Details

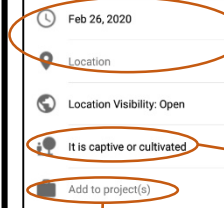

Double check date and location

Is the observation a pet or house plant or in a garden or zoo?

Projects contribute directly to specific data collection efforts. If at HHLT's Granite Mountain Preserve, look for: "Granite Mountain Preserve Biodiversity"

Share your Observation!